

3
 A1.1g
SKATING RINK EAST ELEVATION
 SCALE: N.T.S.

4
 A1.1g
SKATING RINK NORTH & SOUTH ELEVATION
 SCALE: N.T.S.

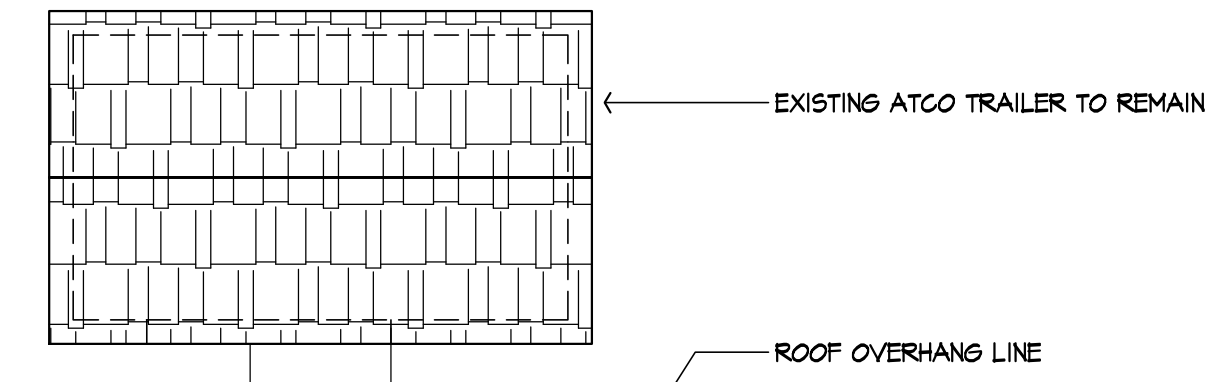

6
 A1.1g
REFERENCE PICTURE
 SCALE: N.T.S.
 SIMILAR DESIGN SCHEME ONLY

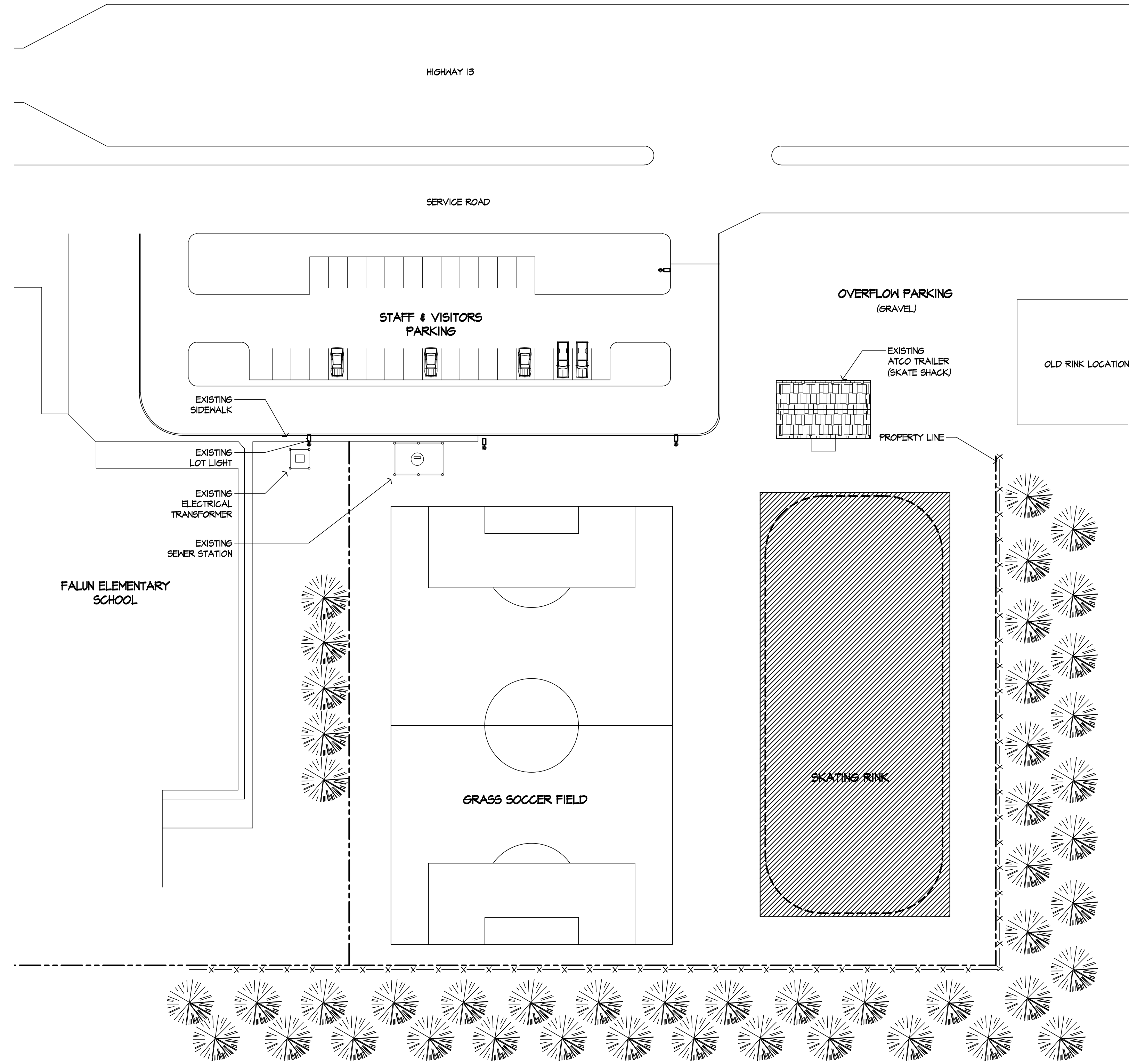

PLAN NORTH
 A1.1g
OVERALL SITE PLAN (Option 3)
 SCALE: 1/32"=1'-0"

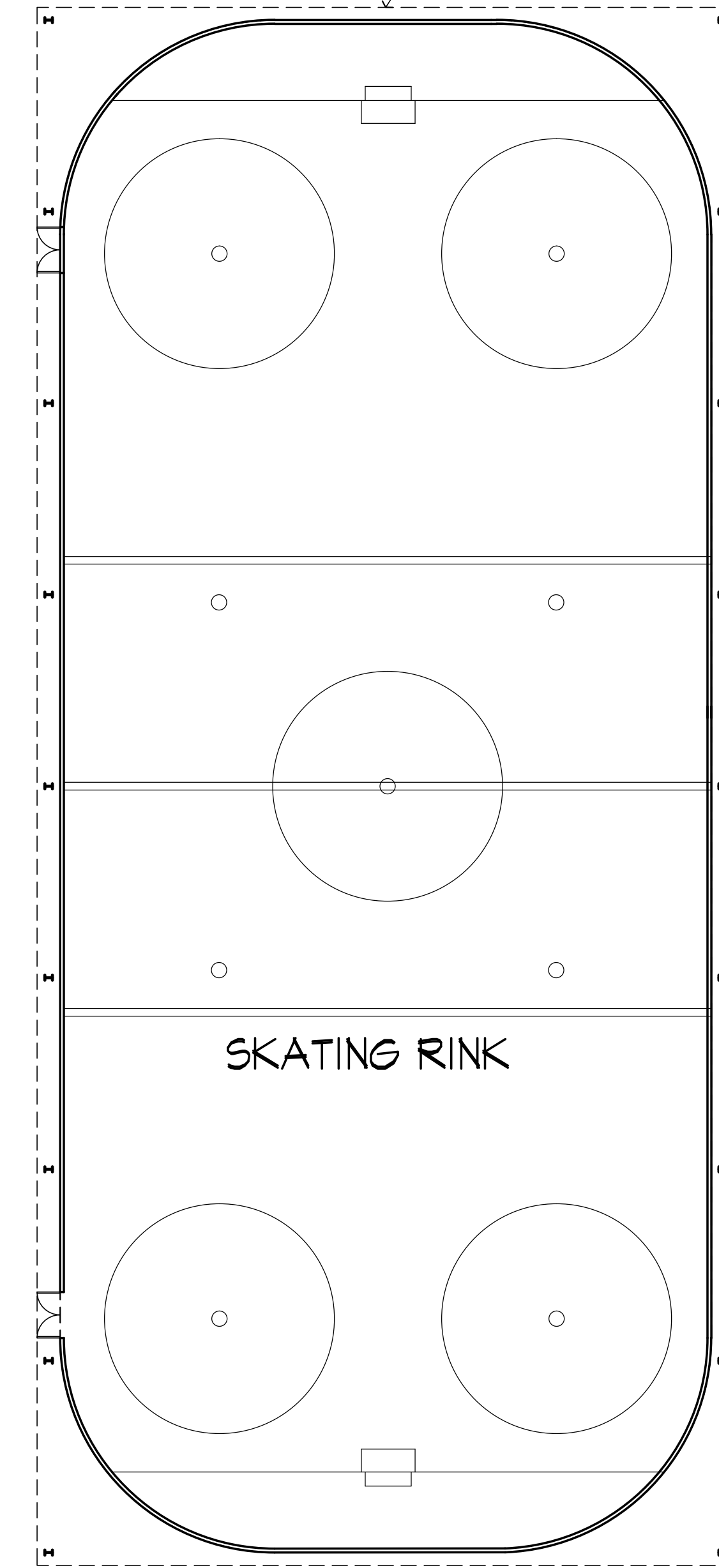

PLAN NORTH
 A1.1g
SKATING RINK PLAN (option 3)
 SCALE: 1/16"=1'-0"

LEGAL:

| Revisions No. | Description | Date |
|---------------|-------------|------------|
| - | Proposed | June 17-10 |
| - | | |

Note

THE IMPERIAL SCALE INDICATED ON THE REFERENCE SYMBOLS APPLY TO DRAWINGS PRINTED FULL SIZE ON 24" X 36" (ARCH D) SHEET SIZE. THE GIVEN SCALE DOES NOT APPLY TO REDUCTIONS OR ENLARGEMENTS OF THE DRAWING SHEETS.

ALL DIMENSIONS SHALL BE VERIFIED BY THE CONTRACTOR. ALL DISCREPANCIES SHALL BE REPORTED TO THE ARCHITECT PRIOR TO COMMENCEMENT OF WORK. DRAWINGS ARE NOT TO BE SCALED FOR MEASUREMENTS.

Project

PROPOSED NEW SKATING RINK

Falun, Alberta

Sheet Title
OVERALL SITE PLAN
 (Option 3)

| | | |
|---------|-------------|-------|
| Scale | As Shown | Sheet |
| Date | June 17-10 | A1.1g |
| Drawn | Ernesto D. | |
| Checked | Chris Laing | |